

NOTE: DO NOT DISCARD the Parts List from the Instruction Bulletin. Place the Parts List in the appropriate place in the machine manual for future reference. Retaining the Parts List will make it easier to reorder individual parts and will save the cost of ordering an entire kit.

NOTE: Numbers in parenthesis () are reference numbers for parts listed in Bill of Materials.

Installation instructions for **kit number 9001321**

SYNOPSIS:

This kit contains the parts needed to install a backup alarm on M20 / T20 machines.
Please follow step-by-step instructions.

SPECIAL TOOLS / CONSIDERATIONS: NONE

(Estimated time to complete: 1 hour)

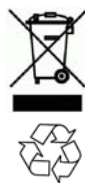

PROTECT THE ENVIRONMENT

Please dispose of packaging materials, used machine components such as batteries and fluids in an environmentally safe way according to local waste disposal regulations.

Always remember to recycle.

PREPARATION:

1. Park the machine on a clean level surface, turn off the machine, remove the key, and set the parking brake.

FOR SAFETY: Before leaving or servicing machine, stop on level surface, set parking brake, turn off machine, and remove key.

2. Disconnect the negative terminal and then the positive terminal from the battery.



WARNING: Always disconnect battery cables from machine before working on electrical components.

INSTALLATION:

1. Use two M5 hex screws (2), two flat washers (3), and two M5 hex nuts (4) to install the backup alarm (1) onto the bracket (5). (Fig. 1)
2. Use three M8 hex screws (6) and three flat washers (7) to install the bracket (5) onto the back of the machine. Do not install the M8 hex screw and washer used to install cable clamp (9) onto the machine. These items are installed later. (Fig. 1)

3. Route the main wire harness backup alarm/revolving light cable from between the recovery and solution tank and up to the backup alarm on the back of the machine. Connect the main wire harness to the warning/backup harness (8). (Fig. 2 / Fig. 3)
4. Connect the backup alarm (1) wires to the warning/backup harness (8). (Fig. 2)
5. Route the excess cable from the backup alarm/ revolving light cable on the main wire harness and the warning/backup harness (8) back down between the recovery tank and solution tank.
6. Neatly bundle the revolving light wires on the warning/backup harness (8) and secure them together with electrical tape or a wire tie.
7. Place the cable clamp (9) onto the warning/ backup harness (8) and use the remaining M8 hex screw (6) and flat washer (7) to secure the cable clamp and warning/backup harness to the bracket (5). (Fig. 1)

8. Reconnect the positive terminal and then the negative terminal to the battery.

9. Start the machine and move the machine in reverse. The backup alarm should sound while machine is moving in reverse.

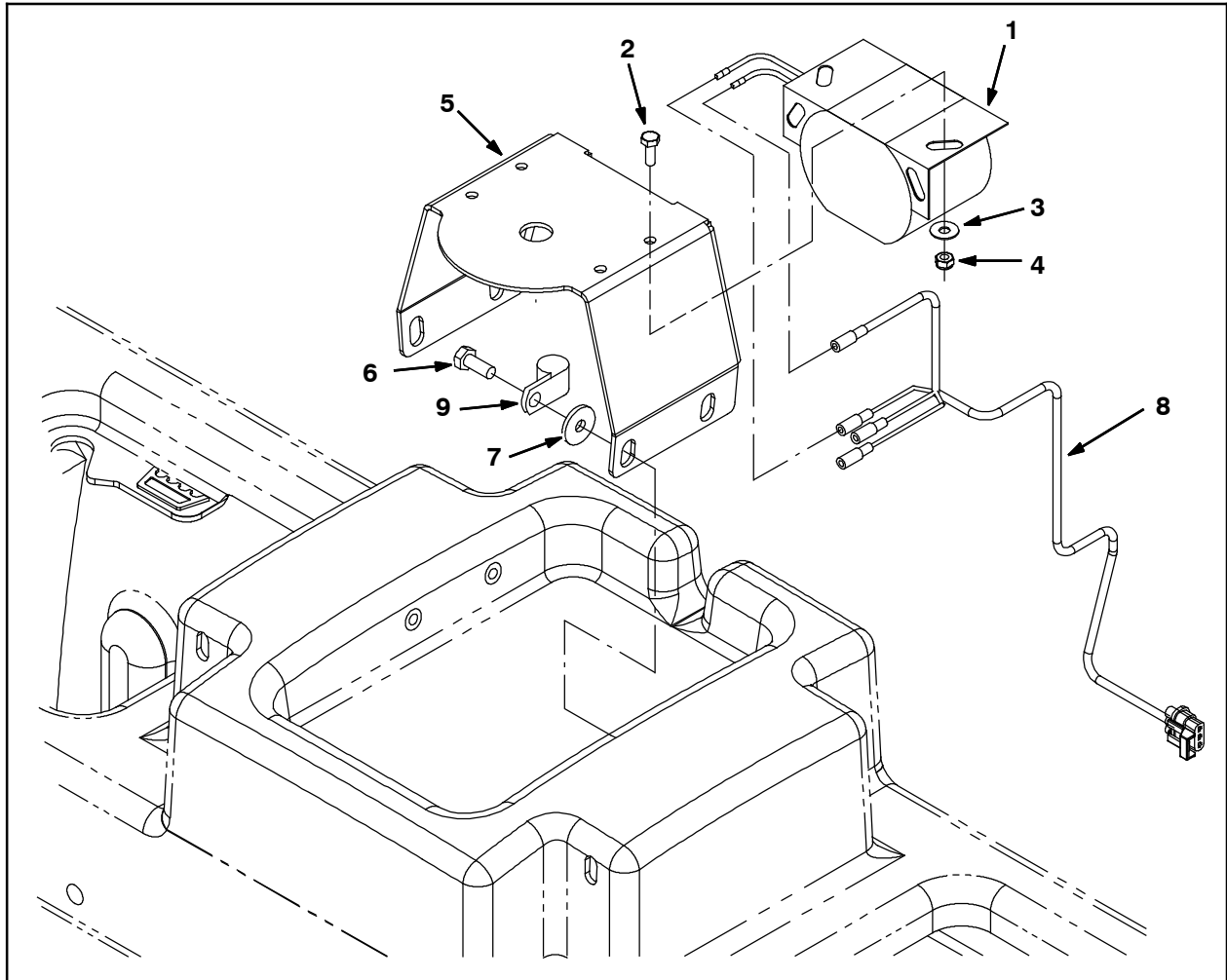

FIG. 1

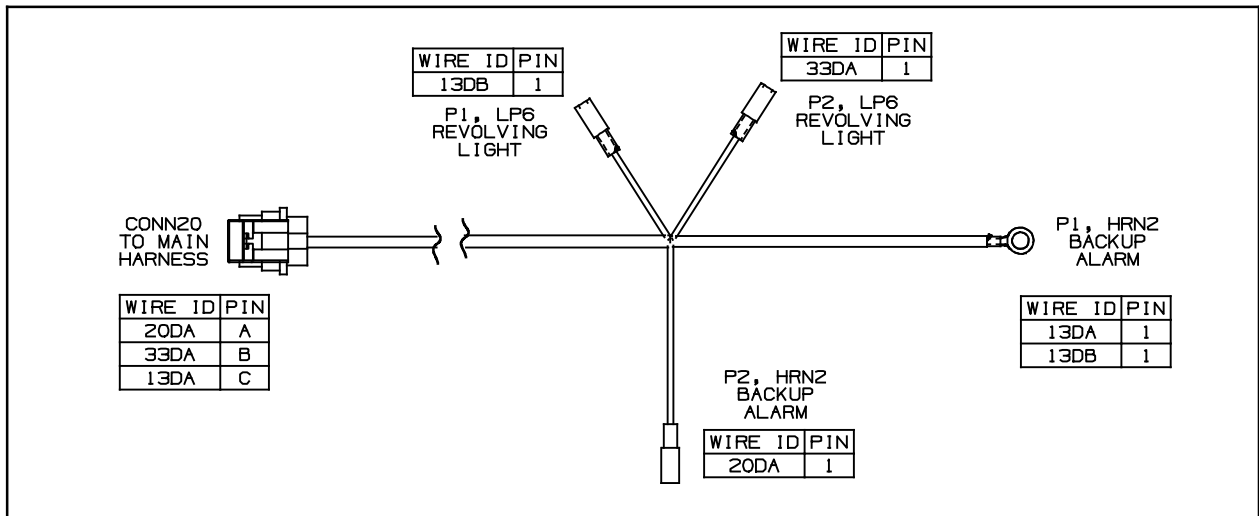

FIG. 2

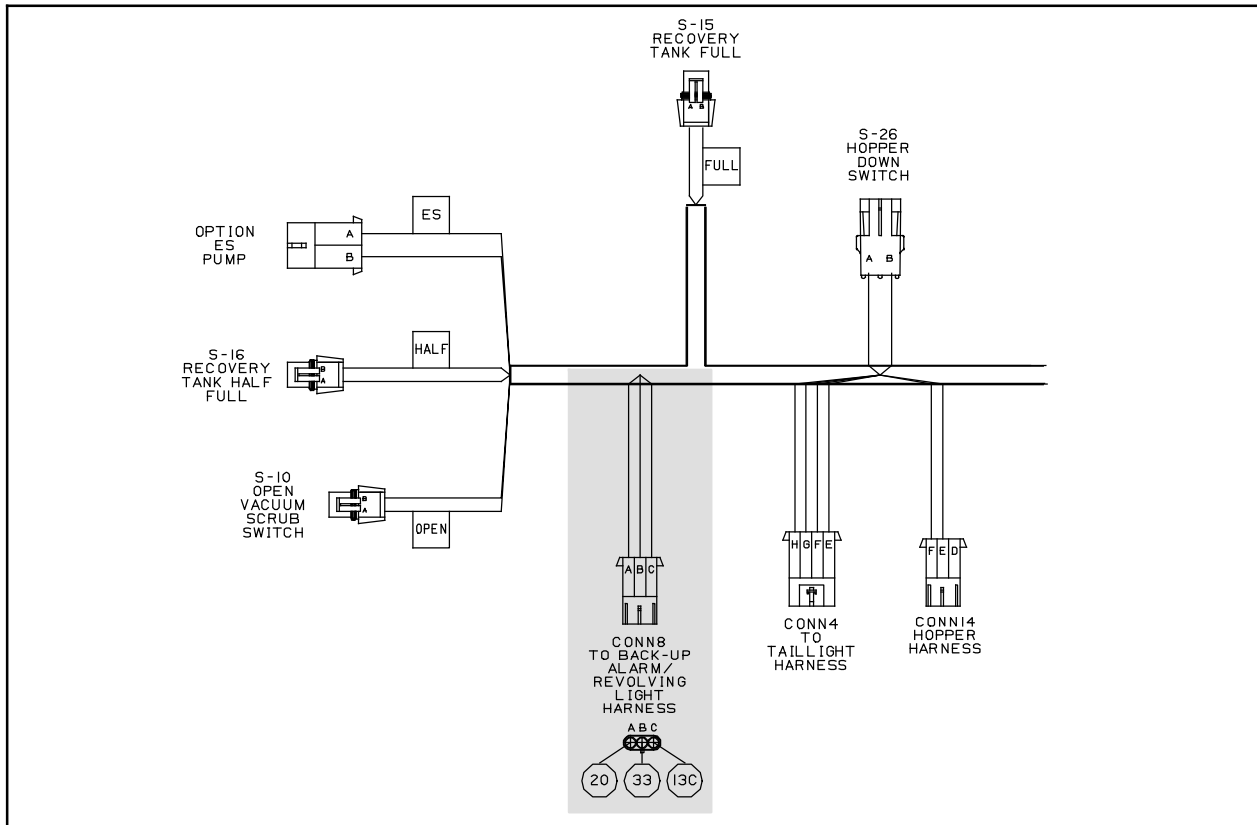

FIG. 3

Bill of Materials for Alarm Kit, Backup, CI [M20 and T20]-9001321

Ref.	Tennant Part No.	Description	Qty.
▽	9001321	Alarm Kit, Backup, CI [M20 And T20]	1
▲	1 9007131	Alarm Assy, Backup, 12/48vdc	1
▲	2 24196	Screw, Pan, M5 X 0.8 X 20, SS	2
▲	3 19066	Washer, Flat, #10	2
▲	4 09739	Nut, Hex, Lock, M5 X 0.80, NL, SS	2
▲	5 1019445	Bracket, Sppt, Revl Light	1
▲	6 09740	Screw, Hex, M8 X 1.25 X 20, SS	4
▲	7 1017218	Washer, Flat, 0.32b 1.00d .12, SS	4
▲	8 1019971	Harness, Warning / Backup [M20 & T20]	1
▲	9 46236	Clamp, Cable, Stl, 0.25d X 0.56w, 1Hole	2

TENNANT COMPANY
P. O. Box 1452
Minneapolis, MN 55440-1452